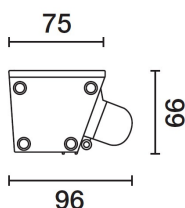

Last information update: October 2024

**Product configuration: BI93**

BI93: Wall-/Ceiling-mounted - Neutral White LED - 100-277V ac - L=528mm - Wall Grazing Spot Optic

**Product code**

BI93: Wall-/Ceiling-mounted - Neutral White LED - 100-277V ac - L=528mm - Wall Grazing Spot Optic

**Technical description**

Direct light luminaire, designed to use monochrome LED lamps. Ceiling- and wall-mounted. Consists of a body and supports for installation, to be ordered separately. Extruded aluminium body, with die-cast aluminium end caps complete with silicone seals. Coated with liquid acrylic paint with a high level of weather and UV ray resistance. Lateral control gear box made of PPS (polyphenylene sulfide). The top of the optical assembly is closed by a 3 mm thick transparent glass screen, fixed with silicone. Complete with multi-LED plate in Neutral White. Fitted with optics with plastic (methacrylate) lens for Wall Grazing Spot lighting. The lateral box is supplied with a double connector, male/female, with 2-pin quick coupling for pass-through wiring and a closing cap on one side. Set up for pass-through earth wiring. All external screws used are made of A2 stainless steel. The luminaire technical characteristics conform to EN 60598-1 standards and particular requirements.

**Installation**

Accessories available for installation:  $\pm 90^\circ$  adjustable arms L=138mm (code 5576), arms extendable from 309 to 389mm and adjustable  $\pm 90^\circ$  (code 5577), bracket for wall-mounting L=310mm (code BZ10), brackets for mounting on balustrades L297mm (code 5578), bracket for surface- or ceiling-mounting L=309mm (code 5570). For a more uniform light beam in the initial few metres, an accessory diffusing filter is available (code BZS8).

**Colour**

Grey (15)

**Mounting**

wall surface/ceiling surface

**Wiring**

The product is supplied with electronic control gear, 220÷240Vac, 50/60Hz contained in the luminaire. Available for electrical connection: IP66 2-pin female connector (X108), IP66 2-pin male connector + closing cap (X109), IP66 2-pin male connector + female connector (X110)

**Notes**

Product complete with LED lamp.

Complies with EN60598-1 and pertinent regulations



IK05

IP66

**Technical data**

Im system:	1147	Colour temperature [K]:	4000
W system:	19.9	MacAdam Step:	3
Im source:	1540	Life Time LED 1:	100,000h - L80 - B10 (Ta 25°C)
W source:	18	Life Time LED 2:	66,000h - L80 - B10 (Ta 40°C)
Luminous efficiency (Im/W, real value):	57.6	Lamp code:	LED
Im in emergency mode:	-	Number of lamps for optical assembly:	1
Total light flux at or above an angle of 90° [Lm]:	0	ZVEI Code:	LED
Light Output Ratio (L.O.R.) [%]:	74	Number of optical assemblies:	1
CRI (minimum):	80	Intervallo temperatura ambiente:	from -30°C to 50°C.

Polar

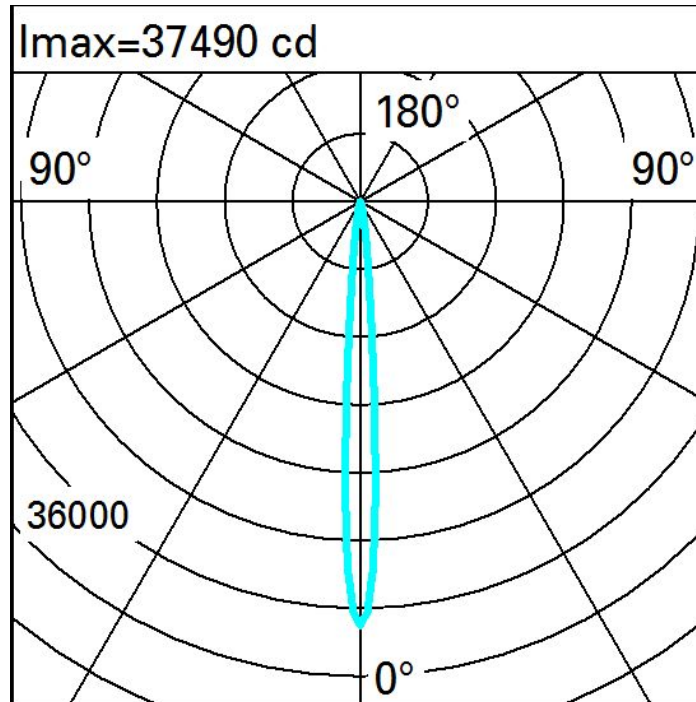

Illuminances

