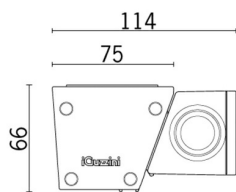

Last information update: May 2024

Product configuration: BH07

BH07: Wall-/Ceiling-mounted - 33 Warm White LEDs - 100-277V ac - L=1585mm - Wall Grazing Optic

**Product code**BH07: Wall-/Ceiling-mounted - 33 Warm White LEDs - 100-277V ac - L=1585mm - Wall Grazing Optic **Attention! Code no longer in production****Technical description**

Direct light luminaire, designed to use monochrome LED lamps. Ceiling- and wall-mounted. Consists of a body and supports for installation, to be ordered separately. Extruded aluminium body, with die-cast aluminium end caps complete with silicone seals. Coated with liquid acrylic paint with a high level of weather and UV ray resistance. Lateral power supply box made of PPS (polyphenylene sulfide). The top of the optical assembly is closed by a 3 mm thick transparent glass screen, fixed with silicone. Complete with multi-LED plate in Warm White 3100K. Fitted with a PMMA diffusing filter and optic with plastic (methacrylate) lens for Wall Grazing lighting. The lateral box is supplied with a double connector, male/female, with 3-pin quick coupling for pass-through wiring and a closing cap on one side. All external screws used are made of A2 stainless steel. The luminaire technical characteristics conform to EN 60598-1 standards and particular requirements.

Installation

Accessories available for installation: $\pm 90^\circ$ adjustable arms L=138mm (code 5576), arms extendable from 309 to 389mm and adjustable $\pm 90^\circ$ (code 5577), bracket for wall-mounting L=350mm (code BZ10), brackets for mounting on balustrades L297mm (code 5578), bracket for surface- or ceiling-mounting L=350mm (code 5570)

Colour

Grey (15)

Weight (Kg)

4.49

Mounting

wall surface/ceiling surface

Wiring

The product is supplied with electronic control gear, 220÷240Vac, 50/60Hz contained in the luminaire. Available for electrical connection: IP66 3-pin female connector (BZ12), IP66 3-pin male connector + closing cap (BZ13), IP66 3-pin male connector + female connector (BZ14), multi-pole cable units with 3-pin male + female connectors (BZJ0-BZJ1-BZJ2)

Notes

Product complete with LED lamp.

Complies with EN60598-1 and pertinent regulations

**Technical data**

Im system:	3267	MacAdam Step:	3
W system:	41.5	Life Time LED 1:	100,000h - L80 - B10 (Ta 25°C)
Im source:	4950	Life Time LED 2:	100,000h - L80 - B10 (Ta 40°C)
W source:	32	Voltage [Vin]:	230
Luminous efficiency (Im/W, real value):	78.7	Lamp code:	LED
Im in emergency mode:	-	Number of lamps for optical assembly:	1
Total light flux at or above an angle of 90° [Lm]:	0	ZVEI Code:	LED
Light Output Ratio (L.O.R.) [%]:	66	Number of optical assemblies:	1
CRI:	80	Intervallo temperatura ambiente:	from -30°C to 50°C.
Colour temperature [K]:	3000	Control:	On/off

Polar

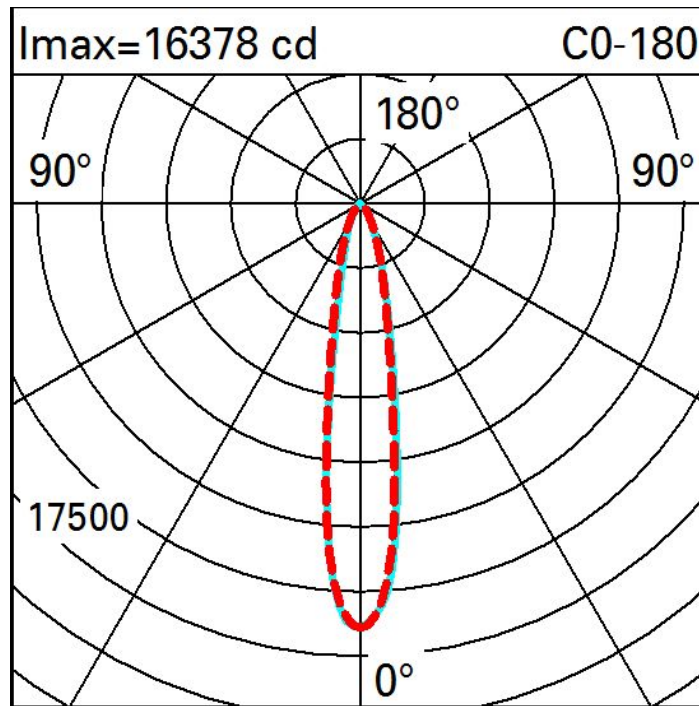

Illuminances

Lux												Wall distance = 1m	
3													
	0.1	0.4	1	3	8	11	8	3	1	0.4	0.1		
2	0.6	1	3	8	19	32	19	8	3	1	0.6		
	1	2	5	23	77	105	77	23	5	2	1		
1	1	3	11	44	76	101	76	44	11	3	1		
	2	6	21	39	69	97	69	39	21	6	2		
0													
	m	-2	-1		0		1	2	3				